

SAFETY HEALTH AND ENVIRONMENTAL INFORMATION	
IN ADDITION TO THE HAZARD/RISKS NORMALLY ASSOCIATED WITH THE TYPES OF WORK DETAILED ON THIS DRAWING, NOTE THE FOLLOWING RISKS AND INFORMATION.	
IDENTIFIED RISKS ARE NOTED IN ETYN-SEF-XXX-XX-HS-Z-0001 RISK REGISTER. REFER TO RISK REGISTER FOR MITIGATION MEASURES. RISKS ASSOCIATED WITH THIS WORKS ELEMENT ARE AS FOLLOWS	
REF.	NAME
21+22	UNFORESEEN UTILITIES
41-48	CONTAMINATED GROUND
49+50	DAMAGE CAUSED TO BUILDINGS DUE TO EXCAVATIONS
54-56	RISK OF DAMAGE TO PEDESTRIANS / ROAD VEHICLES IN CITY CENTRE
FOR INFORMATION RELATING TO USE, CLEANING AND MAINTENANCE SEE THE HEALTH AND SAFETY FILE	
IT IS ASSUMED THAT ALL WORKS WILL BE CARRIED OUT BY A COMPETENT CONTRACTOR WORKING, WHERE APPROPRIATE, TO AN APPROVED METHOD STATEMENT.	

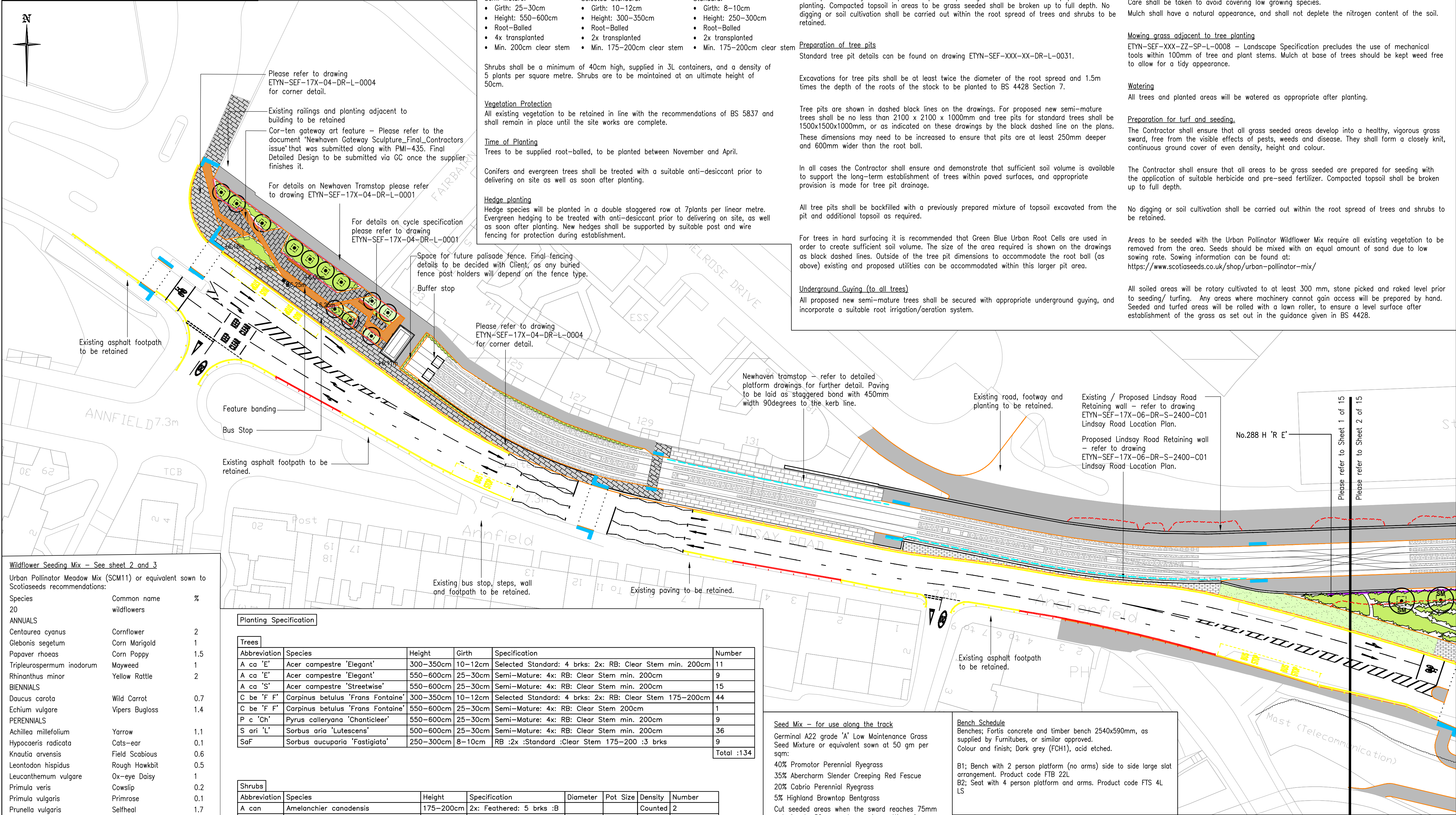

Wildflower Seeding Mix - See sheet 2 and 3		
Urban Pollinator Meadow Mix (SCM11) or equivalent sown to Scotiaseeds recommendations:		
Species	Common name	%
20	wildflowers	
ANNUALS		
Centaura cyanus	Cornflower	2
Glebonis segetum	Corn Marigold	1
Papaver rhoeas	Corn Poppy	1.5
Tripleurospermum inodorum	Mayweed	1
Rhinanthus minor	Yellow Rattle	2
BIENNIALS		
Daucus carota	Wild Carrot	0.7
Echium vulgare	Vipers Bugloss	1.4
PERENNIALS		
Achillea millefolium	Yarrow	0.1
Hypocaeis radicata	Cats-ear	1.1
Knautia arvensis	Field Scabious	0.6
Leontodon hispidus	Rough Hawkbit	0.5
Leucanthemum vulgare	Ox-eye Daisy	1
Primula veris	Cowslip	0.2
Primula vulgaris	Primrose	0.1
Prunella vulgaris	Selfheal	1.7
Ranunculus acris	Meadow Buttercup	1.3
Stachys sylvatica	Hedge Woundwort	0.5
Succisa pratensis	Devils-bit Scabious	0.5
Taraxacum officinalis	Dandelion	0.1
Vicia cracca	Tufted vetch	1.5
80	% grasses	
Alopecurius pratensis	Meadow Foxtail	2
Anthoxanthum odoratum	Sweet Vernal Grass	4
Agrostis capillaris	Common Bent (c)	8
Cynosurus cristatus	Crested-dogs Tail (c)	14
Poa pratensis	Smooth Stalked Meadow Grass (c)	17
Festuca rubra commutata	Chewings Fescue (c)	35

Planting Specification					
Trees					
Abbreviation	Species	Height	Girth	Specification	Number
A ca 'E'	Acer campestre 'Elegant'	300-350cm	10-12cm	Selected Standard: 4 brks: 2x: RB: Clear Stem min. 200cm	11
A ca 'E'	Acer campestre 'Elegant'	550-600cm	25-30cm	Semi-Mature: 4x: RB: Clear Stem min. 200cm	9
A ca 'S'	Acer campestre 'Streetwise'	550-600cm	25-30cm	Semi-Mature: 4x: RB: Clear Stem min. 200cm	15
C be 'F F'	Carpinus betulus 'Frans Fontaine'	300-350cm	10-12cm	Selected Standard: 4 brks: 2x: RB: Clear Stem 175-200cm	44
C be 'F F'	Carpinus betulus 'Frans Fontaine'	550-600cm	25-30cm	Semi-Mature: 4x: RB: Clear Stem 200cm	1
P c 'Ch'	Pyrus calleryana 'Chanticleer'	550-600cm	25-30cm	Semi-Mature: 4x: RB: Clear Stem min. 200cm	9
S ari 'L'	Sorbus aria 'Lutescens'	500-600cm	25-30cm	Semi-Mature: 4x: RB: Clear Stem min. 200cm	36
SaF	Sorbus aucuparia 'Fastigiata'	250-300cm	8-10cm	RB :2x :Standard :Clear Stem 175-200 :3 brks	9
					Total :134
Shrubs					
Abbreviation	Species	Height	Specification	Diameter	Pot Size
A can	Amelanchier canadensis	175-200cm	2x: Feathered: 5 brks :B		Counted
B m	Brachyglottis monroi	40-60cm	Branched: 4 brks: C		2
H 'R E'	Hebe 'Red Edge'		Bushy: 5 brks: C	20-30cm	3L
H a	Hebe albicans		Bushy: 5 brks: C	20-30cm	3L
L an 'H'	Lavandula angustifolia 'Hidcote'	40-60cm	Bushy: 9 brks: C		8L
P t 'V'	Pachysandra terminalis 'Variegata'	40-60cm	Several Shoots: 6 brks: C		3L
P ten 'T T'	Pittosporum tenuifolium 'Tom Thumb'	40-60cm	Bushy: 7 brks: C		10L
* PRULA	Prunus laurocerasus	40-60cm	C :Bushy :3 brks		3L
*Hedge to be planted at 7 plants per linear meter in a double staggered row.					7/m
					Total :13621
Herbaceous					
Abbreviation	Species	Specification	Pot Size	Density	Number
E a r	Euphorbia amygdaloides robbiae	Full Pot: C	3L	5/m²	1841
					Total :1841

Site Preparation
Soil
Existing soil to be utilised on site where possible.
The existing soils (subsoil and topsoil) are expected to be adequate for planting and should be to the following minimum depths:-

Trees - 600-1000mm (max. 400mm topsoil)
Shrubs - 600mm (300mm topsoil)
Seeding - 300mm (150mm topsoil)

The Urban Pollinator Mix (wildflower seeding) is to be sown in 300mm of a 50:50 subsoil and topsoil mix. Subsoil alone can be used, but if the structure is poor and the fertility very low there will be a very slow establishment of seeding and dominated by unwanted plants. Soil testing to be undertaken to verify topsoil fertility prior to site preparation. Sowing should take place in spring (March to June) or autumn (Mid-August to late September).

Should depths of soils not fall within these minimum standards soils depths will be increased using imported soil to BS 3882 or existing approved soil from elsewhere on site. Any topsoil brought onto site must conform to BS 3882 and be approved by the Landscape Architect.

The top 300mm layer of compacted topsoil in planting beds shall be broken up prior to planting. Compacted topsoil in areas to be grass seeded shall be broken up to full depth. No digging or soil cultivation shall be carried out within the root spread of trees and shrubs to be retained.

Preparation of tree pits
Standard tree pit details can be found on drawing ETYN-SEF-XXX-XX-DR-L-0031.

Excavations for tree pits shall be at least twice the diameter of the root spread and 1.5m times the depth of the roots of the stock to be planted to BS 4428 Section 7.

Tree pits are shown in dashed black lines on the drawings. For proposed new semi-mature trees shall be no less than 2100 x 2100 x 1000mm and tree pits for standard trees shall be 1500x1500x1000mm, or as indicated on these drawings by the black dashed line on the plans. These dimensions may need to be increased to ensure that pits are at least 250mm deeper and 600mm wider than the root ball.

In all cases the Contractor shall ensure and demonstrate that sufficient soil volume is available to support the long-term establishment of trees within paved surfaces, and appropriate provision is made for tree pit drainage.

All tree pits shall be backfilled with a previously prepared mixture of topsoil excavated from the pit and additional topsoil as required.

For trees in hard surfacing it is recommended that Green Blue Urban Root Cells are used in order to create sufficient soil volume. The size of the area required is shown on the drawings as black dashed lines. Outside of the tree pit dimensions to accommodate the root ball (as above) existing and proposed utilities can be accommodated within this larger pit area.

Underground Guying (to all trees)
All proposed new semi-mature trees shall be secured with appropriate underground guying, and incorporate a suitable root irrigation/aeration system.

Root Barriers
Root barriers shall be provided at the time of planting, in order to constrain the growth of roots where there is a risk that proposed trees or shrubs would damage, or prevent the normal operation/maintenance of, adjacent utilities, buildings or other susceptible structures.
Root barriers shall be supplied and installed in accordance with the manufacturer's instructions.

Storage of Soil
Site won top soil will be stored in locations as agreed by the Site Manager and in line with the British Standards.

All plants in containers will be watered prior to planting.
All planting areas will be hand stone picked before planting commences.

Mulch
All trees (other than in hard surfaces) and ornamental shrubs to a coarse grade contract bark mulch spread over the entire soil area. A minimum mulch thickness (75mm) in accordance with recommendations of BS 7370: Part 4, shall be applied to protect root systems, prevent surface crust, and suppress weeds, to all areas of planting after watering in.

Care shall be taken to avoid covering low growing species.
Mulch shall have a natural appearance, and shall not deplete the nitrogen content of the soil.

Mowing grass adjacent to tree planting
ETYN-SEF-XXX-ZZ-SP-L-0008 - Landscape Specification precludes the use of mechanical tools within 100mm of tree and plant stems. Mulch at base of trees should be kept weed free to allow for a tidy appearance.

Watering
All trees and planted areas will be watered as appropriate after planting.

Preparation for turf and seeding.
The Contractor shall ensure that all grass seeded areas develop into a healthy, vigorous grass sward, free from the visible effects of pests, weeds and disease. They shall form a closely knit, continuous ground cover of even density, height and colour.

The Contractor shall ensure that all areas to be grass seeded are prepared for seeding with the application of suitable herbicide and pre-seed fertilizer. Compacted topsoil shall be broken up to full depth.

No digging or soil cultivation shall be carried out within the root spread of trees and shrubs to be retained.

Areas to be seeded with the Urban Pollinator Wildflower Mix require all existing vegetation to be removed from the area. Seeds should be mixed with an equal amount of sand due to low sowing rate. Sowing information can be found at: <https://www.scotiaseeds.co.uk/shop/urban-pollinator-mix/>

All soiled areas will be rotary cultivated to at least 300 mm, stone picked and raked level prior to seeding/ turfing. Any areas where machinery cannot gain access will be prepared by hand. Seeded and turfed areas will be rolled with a lawn roller, to ensure a level surface after establishment of the grass as set out in the guidance given in BS 4428.

Do not scale from this drawing.

• EDINBURGH •

THE CITY OF EDINBURGH COUNCIL

SF

Sacyr • Farrans • Neopul

Key

Existing Trees/vegetation to be retained

Existing Trees/vegetation to be removed

Existing/ Proposed walls

Proposed

British Standard Flag Paving in Grey as supplied by Charcon (or similar approved), 450x600x63mm, laid in a staggered bond at 90° to the kerb (or as otherwise stated on these drawings) with 5-10mm joints. Laid in accordance with BS 7533-4*

Caithness natural stone paving flags (castle blend) natural river split top and bottom, sawn sides, 450xrandom lengthsx65mm, laid in a staggered bond with 5-10mm joints. Laid in accordance with BS 7533-4, as supplied by BBS (or similar approved)*

Scoutmoor sandstone natural stone paving (diamond sawn finish), 450x450x63mm, laid in a staggered bond with 5-10mm joints. Laid in accordance with BS 7533-4 as supplied by BBS (or similar approved)*

*For vehicle crossover locations and details / paving buildups please refer to Engineer's roadworks package and construction detail drawings.

Asphalt footpath, to engineers detail

*Pedestrian deterrent paving

*Separator strip paving

*Between York Place and Annandale Junction Ochavo granite, grey rock with medium grain, flamed finish, 80x80x80mm with deep recessed joints. As supplied by BSS (or similar approved). Between Annandale Junction and Newhaven imprinted concrete (same as on tram track).

Cycle route, to engineers detail

Grasscrete; Grassgrid product as supplied by Aggregate Industries (or similar approved), 366x274x100mm

Tactile paving

Ladder tactile paving

Specimen trees; refer to planting schedule and outline specification on sheet 1 for further details

Tree grille (to semi mature trees in hard landscape); Castle grille 1800x1800mm infilled with paving to match surroundings, as supplied by GreenBlue Urban (or similar approved) Orientation of grille to match surrounding paving direction

Linear root barrier; installed for trees in soft adjacent to pavements or utilities, ReaRoot1000 as supplied by GreenBlue Urban (or similar approved)

Grass seeding; refer to outline specification on sheet 1

Ornamental shrub/ herbaceous planting; refer to planting schedule and outline specification on sheet 1 for further details

Raised planter; 3mm Cor-Ten steel 2500(l)x950(w)x950(h) as supplied by IOTA (or similar approved)

Cycle stands; galvanised steel 'Sheffield' stands (700-1000m in length and 750 high), 8no. at each location, as supplied by Broxap (or similar approved)

Litter bin; to match the existing type currently deployed by City of Edinburgh Council within the boundaries of the site

Bench; refer to bench schedule on sheet 1 for further details

ACO Multidrain channel - Please refer to drainage drawings for further details

Kerbs - Please refer to engineers drawings for further details

C02	17.08.21	DD+ UPDATES BASED ON DRN COMMENTS	SDR	ER	ER
C01	18.08.21	DD+ UPDATES BASED ON UPDATED ENGINEERING INFO, DRN COMMENTS & ISSUE FOR CONSTRUCTION	SDR	ER	ER
P04	25.02.21	DD+ UPDATES BASED ON UPDATED ENGINEERING INFORMATION AND DRN COMMENTS	SDR	ER	ER
P03	21.08.20	DD+ UPDATES BASED ON DRN AND WORKSHOP COMMENTS AND UPDATED SCHEME ELEMENTS	SDR	LF	ER
P02	09.08.20	REVISED FOLLOWING SFN COMMENTS	SDR	LF	ER
Rev.	Date	Description	Drawn.	Chkd.	Appd.

SENER FAIRHURST

Project Title:

EDINBURGH TRAM
YORK PLACE TO NEWHAVEN

Drawing Title:

LANDSCAPE PROPOSALS
DETAILED DESIGN
SHEET 1 OF 15

Scale at A1:

1:500

Status:

FOR CONSTRUCTION

Drawn:

SDR

Checked:

LF

Approved:

ER

Date:

20/03/20

Date:

01/05/20

Date:

01/05/20

Project

Originator

Volume

Location

Type

Role

Number

ETYN-SEF-XXX-XX-DR-L-0016

Subability:

A1

Revision:

C02

Seed Mix - for use along the track
Germinal A22 grade 'A' Low Maintenance Grass Seed Mixture or equivalent sown at 50 gm per sqm:
40% Promator Perennial Ryegrass
35% Aberchrm Slender Creeping Red Fescue
20% Cabrio Perennial Ryegrass
5% Highland Browntop Bentgrass
Cut seeded areas when the sward reaches 75mm reducing to 50mm and removing cuttings from site. Seeding prices shall include the first two cuts and any overseeding necessary to achieve a continuous sward.

Seed Mix - for grass verges
Germinal A18 Road Verge and Embankments or equivalent sown at 35 gm per sqm:
40% Dipper Strong Creeping Red Fescue
20% Tetriss Smooth Stalked Meadow Grass
12.5% Pillar Perennial Ryegrass
10% Joanna Chewings Fescue
10% Zurich Perennial Ryegrass
5% Highland Browntop Bentgrass
2.5% Aberace (small) W Clover

Bench Schedule
Benches; Fortis concrete and timber bench 2540x590mm, as supplied by Fumitubes, or similar approved.
Colour and finish; Dark grey (FCH1), acid etched.

B1; Bench with 2 person platform (no arms) side to side large slat arrangement. Product code FTB 22L
B2; Seat with 4 person platform and arms. Product code FTS 4L LS

NOTES
1. ALL DIMENSIONS ARE IN MILLIMETRES UNLESS NOTED OTHERWISE.
2. ALL LEVELS ARE IN METRES ABOVE ORDNANCE DATUM (m aod) UNLESS NOTED OTHERWISE.
3. FOR DETAILS OF CARRIAGEWAY AND PAVED AREAS SITE CLEARANCE REFER TO DRAWINGS ETYN-SEF-XXX-09-DR-D-0101 TO 0115
4. INFORMATION ON THIS DRAWING IS FOR THE DISCIPLINE INDICATED IN THE DRAWING TITLE AND SHOULD NOT BE USED FOR ANY OTHER PURPOSE OR DESIGN.
5. HATCHING SHOWN ON PLANS AND KEY IS A GRAPHICAL REPRESENTATION OF PRODUCT ONLY AND IS NOT TO DEMARK LAYING PATTERN OF PAVING. NOTES AND OR DETAILS WILL STATE LAYING PATTERN.
6. THE LANDSCAPE PROPOSAL DRAWINGS ARE TO BE READ IN CONJUNCTION WITH THE ENGINEERING PACKAGES INCLUDING; ROADWORKS; KERBS; FOOTWAYS AND PAVED AREAS; ROAD MARKINGS; ROAD SIGNS AND SIGNALS; STREET LIGHTING; DRAINAGE WORKS AND TRAM ALIGNMENT. THEY SHOULD ALSO BE READ IN CONJUNCTION WITH THE ACCOMMODATION WORKS PACKAGE.
7. DRAWING TO BE READ IN CONJUNCTION WITH LANDSCAPE CONSTRUCTION DETAIL DRAWINGS ETYN-SEF-XXX-XX-DR-L-0031-0034.
8. DRAWING TO BE READ IN CONJUNCTION WITH KERBS, FOOTWAYS AND PAVED AREAS STANDARD DETAILS SHEETS 1-2
9. PAVING EXTENT SHOWN BASED ON ENGINEERING ROADWORKS PACKAGE.
10. FOR WAYFINDING/TRAFFIC SIGNS PLEASE REFER TO DRAWINGS ETYN-SEF-XXX-03-DR-D-1201 - ETYN-SEF-XXX-03-DR-D-1215